

INTERMERCATO

HIGH PERFORMANCE LIFT & LOAD ATTACHMENTS

Pole grabs TG PG

For safe handling of poles and pipes
Intermercato's pole grab is extra wide and the inside of the claws have an interchangeable bolt-on surface layer made of PU for extra gentle handling. Perfectly suitable under worm drive of tilt rotator.



KEY FEATURES

- Made of Hardox®
- Homogeneous guide bars made of Hardox®
- Claws with bolt-on surface layer made of PU
- Suitable for mounting on crane or rigid mounting on excavator
- Cylinder with double piston rod seals for high pressure

DEFINITELY A BEAST.

www.intermercato.com

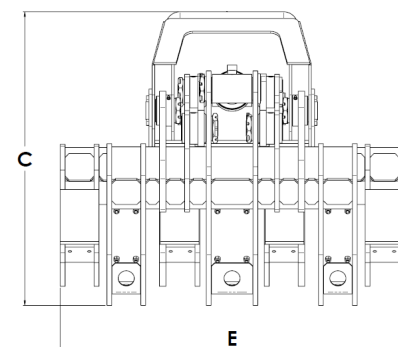
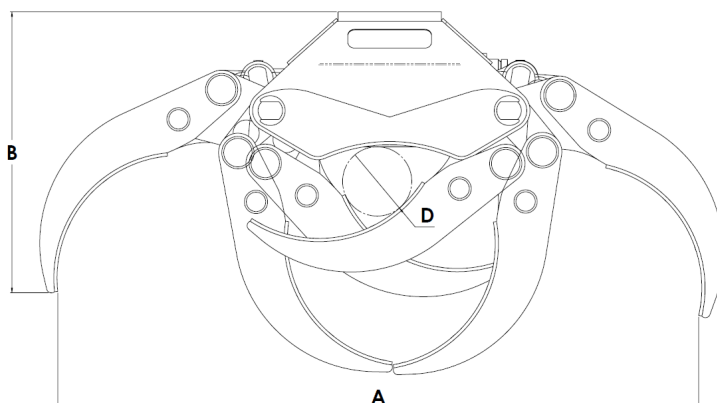

	TG 16 PG	TG 25 PG	TG 42 PG
A	870	1255	1986
B	402	705	869
C	410	780	908
D	105	120	220
E	635	885	1065

MODEL SPECS.	 Kg	 m²	 Bar	 l/min	 kN	 ton	 tm	 tm	 ton	 ton	
TG 16 PG	92	0,04	200	40	6,7	1-4	-	6-28	1-5	1-4	-
TG 25 PG	300	0,22	250	50	14,5	5-10	-	12-32	3-10	3-8	-
TG 42 PG	693	0,38	250	60	23,6	10-15	-	25-50	10-22	10-20	-

Recommended machine weight and crane size

Accessorize your grab

Excavator attachment and rotator

Accessorize your grab with an excavator attachment! We have suitable attachments for all types of excavators. We can also deliver all our grabs and clamshell buckets complete with hose kit!

Accumulator and check valve

Can also be equipped with accumulator from Parker and check valve.



Intermercato is not only grapples - Explore our complete range of products on www.intermercato.com, or contact our proficient sales team.

INTERMERCATO

High performance lift and load attachments for Forestry, Transport, Construction and Recycling.



www.intermercato.com | info@intermercato.com | Tel +46 (0)414 20525 | SE-272 93 Tommarp, Sweden