

Indexator / *GV 124 S - 203*

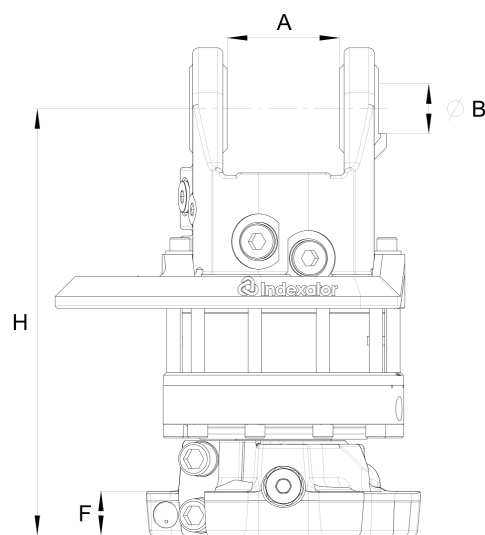

KEY FEATURES

- Fitted with extra hydraulic channels which make it possible to install additional equipment, such as grapple saws and harvester heads.
- Robust, tried and tested design
- Superior material selection
- Low pressure drops

A	101
B	Ø45
C	Ø203
D	Ø21
F	30
H	385
K	44
L	Ø248
M	410

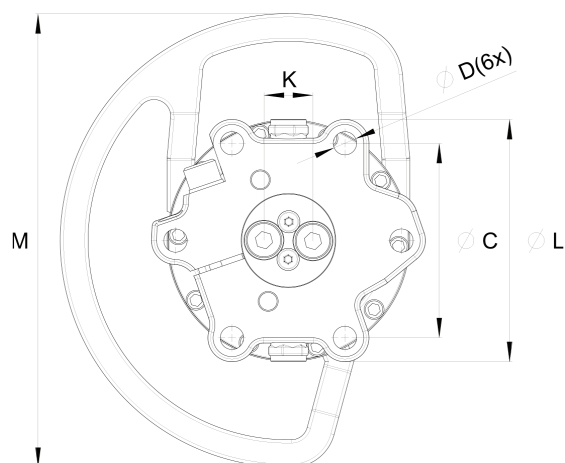

MODEL SPECIFICATIONS



GV 124 S - 203

66

10

250

25

360°

2200

1/2" / 3/4"

INTERMERCATO®

High performance lift and load
attachments for Forestry, Transport,
Construction and Recycling.

